



Spare Parts

Product	Page
Screws / Set Screws	8-1
Nuts	8-10
Spacer Rings	8-12
Reducing Bushings / Reducing Rings	8-17
Ball Bearings	8-21
Accessory Tools	8-23

Torque for Screws

Hexagon Socket Set Screws (DIN 913...916)

Thread	Width across flats [mm]	Tightening moment MA (nm) for property class 45H
M3	1.5	0.82
M4	2.0	1.90
M5	2.5	3.50
M6	3.0	5.50
M8	4.0	9.50
M10	5.0	20.0
M12	6.0	30.0

Hexagon Socket Set Screws (DIN 912)

Thread	Width across flats [mm]	Tightening moment MA (nm) for property class 8.8
M3	2.5	1.1
M4	3.0	2.5
M5	4.0	5.0
M6	5.0	10.0
M8	6.0	15.0
M10	8.0	15.0
M12	10.0	15.0

Screws with Torx

Thread	Torx-Size	Torque MA [Nm] for property class
M2.5	T8	1.31
M3	T9	2.30
M3.5	T15	2.95
M4	T15	5.20
M4x0.5	T9	2.00
M4.5	T15	5.20
M5	T15	8.00
M5	T20	8.60
M6	T25	15.00
M7	T30	15.00

995161

Set Screws - with hexagon socket and cup point

Drawing

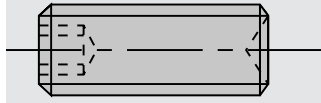

Notes

- | with hexagon socket and cup point
- | packing unit 10 pieces

Dimension

Ident-No.

M5x4 DIN EN ISO 4029	001608
M5x5 DIN EN ISO 4029	001609
M6x4 DIN EN ISO 4029	167068
M6x6 DIN EN ISO 4029	180003
M6x5 DIN EN ISO 4029	165049
[mm]	

995161

Set Screws - with hexagon socket and flat point

Drawing

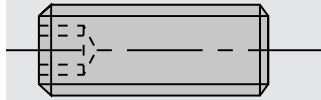

Notes

- | with hexagon socket with flat point
- | packing unit 10 pieces

Dimension

Ident-No.

M5x10 DIN EN ISO 4026	180028
M6x6 DIN EN ISO 4026	163546
M6x8 DIN EN ISO 4026	180036
M8x10 DIN EN ISO 4026	059549
[mm]	

995161

Set Screws - with hexagon socket and cone point

Drawing

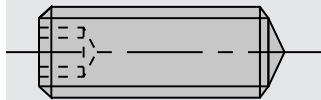

Notes

- | with hexagon socket with cone point
- | packing unit 10 pieces

Dimension

Ident-No.

M5x10 DIN EN ISO 4027	001686
[mm]	



995161

Set Screws - with hexagon socket and dog point

Drawing

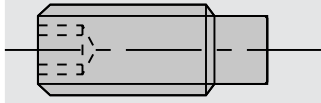

Notes

- | with hexagon socket with dog point
- | packing unit 10 pieces

Dimension

Ident-No.

M5x8 DIN EN ISO 4028	180015
M5x12 DIN EN ISO 4028	050565
M6x6 DIN EN ISO 4028	163841
M6x10 DIN EN ISO 4028	180002
M6x12 DIN EN ISO 4028	180214
M6x16 DIN EN ISO 4028	001617
M6x25 DIN EN ISO 4028	167979
M8x10 DIN EN ISO 4028	001622
M8x12 DIN EN ISO 4028	180001
M8x14 DIN EN ISO 4028	168453
M8x16 DIN EN ISO 4028	164422
M8x20 DIN EN ISO 4028	001625
M8x35 DIN EN ISO 4028	165937
M10x12 DIN EN ISO 4028	001630
M10x16 DIN EN ISO 4028	168192
M10x20 DIN EN ISO 4028	815807
M10x25 DIN EN ISO 4028	168108
M12x25 DIN EN ISO 4028	181466

[mm]

995161

Set Screws - with hexagon socket and ball pressure screw

Notes

- | with hexagon socket and ball pressure screw
- | packing unit 10 pieces

Dimension

Ident-No.

M8x20	168874 o
-------	----------

[mm]

995162

Set Screws - with flat point

Drawing

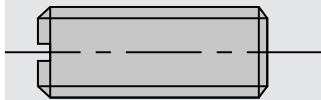

Notes

- | slotted with flat point
- | packing unit 10 pieces

Dimension

Ident-No.

M5x10 DIN EN ISO 4766	001600
-----------------------	--------

[mm]

995111

Head Cap Screws - with hexagon socket

Drawing

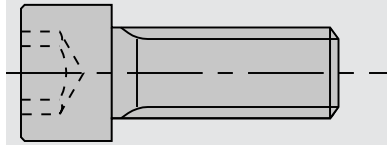

Notes

- | with hexagon socket
- | packing unit 10 pieces

Dimension

Dimension	Ident-No.
M5x40 DIN EN ISO 4762	001875 s
M6x16 DIN EN ISO 4762	001879
M6x40 DIN EN ISO 4762	001884
M8x10 DIN EN ISO 4762	001890 s
M10x50 DIN EN ISO 4762	001909
M12x30 DIN EN ISO 4762	001917
M12x50 DIN EN ISO 4762	001921
M16x40 DIN EN ISO 4762	001933 s
M16x50 DIN EN ISO 4762	166442
M16x50L DIN EN ISO 4762	166431
M16x70 DIN EN ISO 4762	059169
M16x120 DIN EN ISO 4762	001938 s
M20x50 DIN EN ISO 4762	166441
M20x50L DIN EN ISO 4762	166440
M20x80 DIN EN ISO 4762	056178
M20x120 DIN EN ISO 4762	056153 s

[mm]

995111

Head Cap Screws - with hexagon socket with low head

Drawing

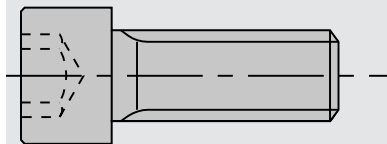

Notes

- | with hexagon socket with low head
- | packing unit 10 pieces

Dimension

Dimension	Ident-No.
M5x16	165961
M8x16	180004
M8x30	180005
M8x50	180006

[mm]



995115

Head Cap Screws - with Torx

Drawing

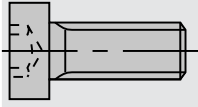

Notes

- | with Torx
- | packing unit 10 pieces

Dimension

Ø D

Ident-No.

M2,5x3 T8	3,45	168237
M2,5x4 T8	3,45	168238
M3x5,5 T8	4,35	168239
M3x10 T8	4,4	168782
M3,5x3,8 T15	7,0	162645
M3,5x5,5 T15	6,0	168236
M3,5x6,5 T15	6,2	163223
M3,5x6,5 T15	7,0	162644
M3,5x8 T15	6,25	163222
M5x12 T20	8,5	171237
[mm]	[mm]	

995122

Countersunk Screws - slotted

Drawing

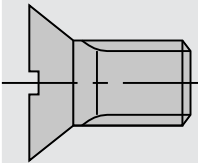

Notes

- | slotted
- | packing unit 10 pieces

Dimension

Ident-No.

M4x8-8.8 DIN EN ISO 10642	183683
M5x10-8.8 DIN EN ISO 2009	055881
M5x12-5.8 DIN 87	180007
[mm]	

995125

Countersunk Screws - with hexagon socket

Drawing

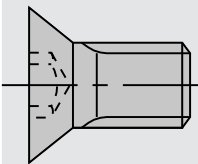

Notes

- | with hexagon socket
- | packing unit 10 pieces

Dimension

Ident-No.

M6x12 SW4	900612
[mm]	

995 125

Countersunk Screws - with Torx

Drawing

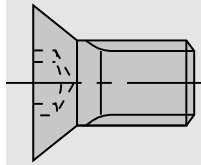

Notes

- | with Torx
- | packing unit 10 pieces

Dimension

Ident-No.

M2,5x5,5 T8		167486
M3x7,3 T8		166502
M3,5x5,5 T15		162649
M3,5x6 T15		162648
M4x0,5x3,2 T9		163925
M4x0,5x4,2 T9		165908
M4x0,5x5,3 T9		170202
M5x6 T20		176199
M5x6,8 T15		180839
M5x8 T20		164005
M5x9 T20 D=Ø9,3		827277
M5x10 T20	for attaching the saw blade without flange	171236
M5x10,8 T15		180840
M5x12 T20		166709
M5x13,5 T20	with collar 6,3 mm	171238
M5x15,5 T20		182112
M5x16 T20	for attaching the flange	164839
M6x10 T20		181244

[mm]

995 190

Cutter Retaining Bolts

Drawing

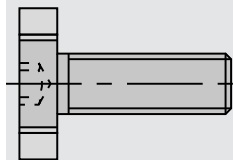

Notes

- | with hexagon socket

Dimension

Ident-No.

M8x23xØ20		171393 s
M10x26xØ28		171392
M12x22xØ35		173591 s
M16x26xØ42		173592
M16x38xØ48	with centering ring	184061

[mm]



995190

Stop Screws

Drawing

Notes

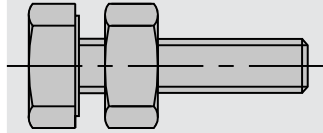

- | for shank-type tools
- | packing unit 10 pieces

Dimension

Ident-No.

M8x25	stop screw	172828
M6x16	for shank Ø 16	172797
[mm]		

995195

Stop Screws - with Torx

Drawing

Notes

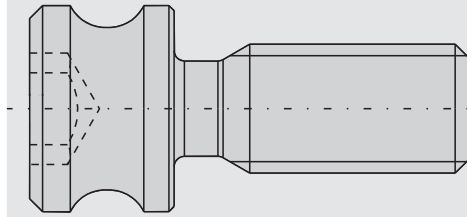

- | for clamping chucks Weeke
- | packing unit 10 pieces

Dimension

Ident-No.

M5x17		186017
[mm]		

995190

Safety Screws

Drawing

Notes

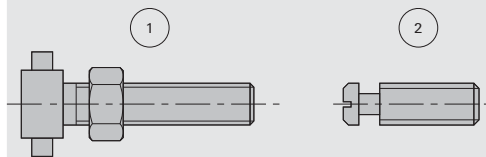

- | for ps-System and PS 2000-E

Dimension

Ident-No.

1	M6x20	for ps-System 16 mm	Ident-No. 168674	172115
1	M8x25	for ps-System 25 mm	Ident-No. 173752	172113
2	M8x19	for PS-2000 E	Ident-No. 173352	172921
	[mm]			

995191

Special Set Screws

Drawing

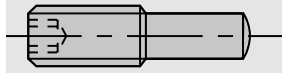

Notes

- | for SuperProfiler "MAN"
- | with hexagon socket
- | packing unit 10 pieces

Dimension

Ident-No.

M8x24

167269

[mm]

995191

Screws

Drawing

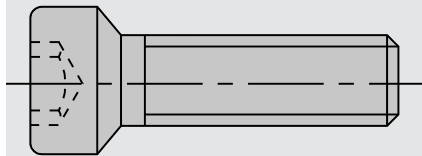

Notes

- | for "Klack" bottom part
- | packing unit 10 pieces

Dimension

Ident-No.

M8x24L

180013 #

M8x24R

180012 #

[mm]

995192

Countersunk Screws - with collar

Drawing

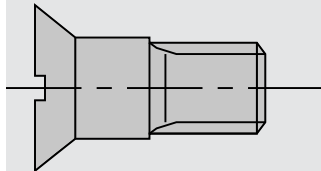

Notes

- | with collar
- | packing unit 10 pieces

Dimension

Ident-No.

M5x12

180009

[mm]

995192

Countersunk Screws - for hogger segments

Drawing

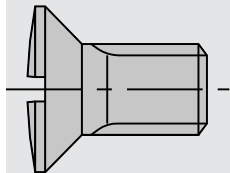

Notes

- | for hogger segments
- | safety screws

Dimension

Ident-No.

M8x12,5

180010

M8x17

180011

[mm]



995 195

Round Head Screws

Drawing

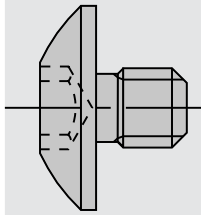

Notes

- | with Torx
- | packing unit 10 pieces

Dimension

Ident-No.

M3,5x4 T15	head Ø 9	168893
M3,5x6 T15	head Ø 9	177549
M3,5x12 T15	head Ø 9	171067
M4x5,9 T15	head Ø 9	167966
[mm]		

995210

Hexagon Nuts

Drawing

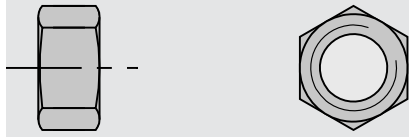

Dimension

Ident-No.

M4 DIN EN ISO 4032

009631

M6 DIN EN ISO 4032

009633 s

[mm]

995290

Special Nuts

Drawing

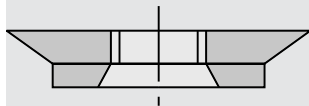

Notes

- | for grooving cutterhead turnover knives
- | packing unit 10 pieces

Dimension

Ident-No.

M4x0,5x1,6

163704

M4x0,5x2,2

163703

M4x0,5x2,75

165907

M4x0,5x4,1

170203

[mm]

995290

Union Nuts

Drawing

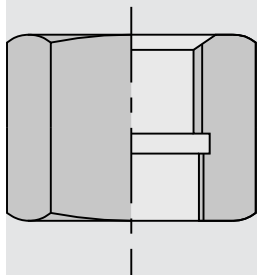

Notes

- | for MK-shanks

Dimension

Ident-No.

M33x3/M30x1,5

double-edged

170275 o

W 1 1/8"/W20x14

hexagonal

167911 o

W 1 1/8"/M30x1,5/L

hexagonal

167780

W 1 1/8"/M30x1,5

hexagonal

165561

[mm]



995290

Clamping Nuts

Drawing

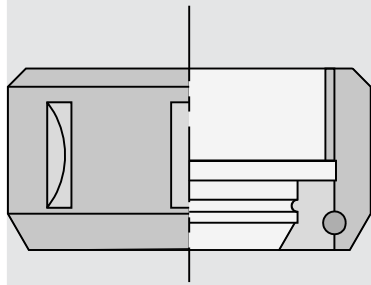

Notes

I for draw-in collet chucks

Dimension

Ident-No.

M30x1,5R	with ball-bearing	178763
M40x1,5R	with slide bearing	178761
M48x2R	with slide bearing	178764
M50x1,5R	with slide bearing	178762 o
[mm]		

955520

Spacers

Ø D	B	Ø d	DKN	NL	Ident-No.
14	0,1	6,0			176422 o
14	0,2	6,0			176423 o
14	0,5	6,0			176424 o
14	1,0	6,0			176425 o
14	2,0	6,0			176426 o
14	5,0	6,0			176427 o
40	0,1	20			000218
40	0,2	20			000219
40	0,5	20			000220
40	1,0	20			000221
40	2,0	20			000222
40	3,0	20			000223
80	0,05	22		2/4/42	017424
80	0,1	22		2/4/42	017425
80	0,2	22		2/4/42	017426
40	0,1	25			183756
40	0,2	25			183757
40	0,5	25			183758
40	1,0	25			183759
40	2,0	25			183760
40	4,0	25			183761
40	6,0	25			183762
40	10	25			183763 s
40	20	25			183764
45	0,1	25	10x3,3	2/5,5/35 + 4/6,5/36	185391
45	0,2	25	10x3,3	2/5,5/35 + 4/6,5/36	185392
45	0,5	25	10x3,3	2/5,5/35 + 4/6,5/36	185393
45	1,0	25	10x3,3	2/5,5/35 + 4/6,5/36	185394
45	2,0	25	10x3,3	2/5,5/35 + 4/6,5/36	185395
45	3,0	25	10x3,3	2/5,5/35 + 4/6,5/36	185396
50	0,1	30			000242
50	0,2	30			000243
50	0,5	30			000244
50	1,0	30			000245
50	2,0	30			000246
50	3,0	30			000247
65	0,1	30	10x3,3	2/7/45 + 8/7/48	185397
65	0,2	30	10x3,3	2/7/45 + 8/7/48	185398
65	0,5	30	10x3,3	2/7/45 + 8/7/48	185399
65	1,0	30	10x3,3	2/7/45 + 8/7/48	185400
65	2,0	30	10x3,3	2/7/45 + 8/7/48	185401
65	3,0	30	10x3,3	2/7/45 + 8/7/48	185402
65	4,0	30	10x3,3	2/7/45 + 8/7/48	185403
65	10	30	10x3,3	2/7/45 + 8/7/48	185404
90	1,0	30			000311
90	2,0	30			000312 s
90	3,0	30			000313 s
100	0,1	30			000320
100	0,2	30			000321
100	0,5	30			000322
100	1,0	30			000323
100	2,0	30			000324 s
100	3,0	30			000325 s
175	0,1	30			000458 s
175	0,2	30			000459 s
175	0,5	30			000460 s
175	1,0	30			000461 s
70	0,1	35	12x4	4/11/54 + 6/7/58	185405
70	0,2	35	12x4	4/11/54 + 6/7/58	185406
70	0,5	35	12x4	4/11/54 + 6/7/58	185407
[mm]	[mm]	[mm]	[mm]		



Ø D	B	Ø d	DKN	NL	Ident-No.
70	1,0	35	12x4	4/11/54 + 6/7/58	185408
70	2,0	35	12x4	4/11/54 + 6/7/58	185409
70	3,0	35	12x4	4/11/54 + 6/7/58	185410
70	4,0	35	12x4	4/11/54 + 6/7/58	185411
70	10	35	12x4	4/11/54 + 6/7/58	185412
70	25	35			170363 s
100	0,1	35			000326
100	0,2	35			000327
100	0,5	35			000328
100	1,0	35			000329
100	2,0	35			000330 s
100	3,0	35			000331
70	0,1	40	14x3,5	4/8/55 + 4/7/58	185413
70	0,2	40	14x3,5	4/8/55 + 4/7/58	185414
70	0,5	40	14x3,5	4/8/55 + 4/7/58	185415
70	1,0	40	14x3,5	4/8/55 + 4/7/58	185416
70	2,0	40	14x3,5	4/8/55 + 4/7/58	185417
70	3,0	40	14x3,5	4/8/55 + 4/7/58	185418
70	4,0	40	14x3,5	4/8/55 + 4/7/58	185419
70	10	40	14x3,5	4/8/55 + 4/7/58	185420
120	0,1	40			000344
120	0,2	40			000345
120	0,5	40			000346
120	1,0	40			000347
120	2,0	40			000348
90	0,1	50			000314
90	0,2	50			000315
90	0,5	50			000316
90	1,0	50			000317
90	2,0	50			000318
90	3,0	50			000319
100	0,05	50		4/9/80	177019 s
100	0,1	50		4/9/80	176835
100	0,2	50		4/9/80	176836
100	0,5	50		4/9/80	176837
100	1,0	50		4/9/80	176838
100	2,0	50		4/9/80	176839 s
100	3,0	50		4/9/80	176840 s
90	0,05	60		3/9/74	177022
90	0,1	60		3/9/74	177023
90	0,2	60		3/9/74	177024
90	0,5	60		3/9/74	177025
90	1,0	60		3/9/74	177026
90	2,0	60		3/9/74	177027
100	0,1	60			000332
100	0,2	60			000333
100	0,5	60			000334 s
100	1,0	60			000335
100	2,0	60			000336
100	3,0	60			000337
119	5,0	60			185365
119	39,5	60			185044
119,5	51	60		4/9/100	179471
120	0,1	60		4/9/100	176830
120	0,15	60		4/9/100	177018
120	0,2	60		4/9/100	176831
120	0,5	60		4/9/100	176832
120	1,0	60		4/9/100	176495
120	2,0	60		4/9/100	176833
120	3,0	60		4/9/100	176834
130	4,2	60			182200 s
130	4,3	60			182201 s
130	4,4	60			182202 s
130	4,5	60			182203 s
[mm]	[mm]	[mm]	[mm]		

Ø D	B	Ø d	DKN	NL	Ident-No.
130	4,6	60			182204 s
130	4,7	60			182205 s
130	4,8	60			182206 s
130	4,9	60			182207 s
130	5,0	60			182208 s
160	0,1	60			000452
160	0,2	60			000453
160	0,5	60			000454
160	1,0	60			000455
160	2,0	60			000456
160	3,0	60			000457 s
115	1,0	80		4/10/100	009255
130	4,5	65			182209 s
130	4,6	65			182210 s
130	4,7	65			182211 s
130	4,8	65			182212 s
130	4,9	65			182213 s
130	5,0	65			182214 s
100	7,6	70			180940
100	11,4	70			180941
120	0,1	80		4/9/100 + 2/6,5/90	177380
120	0,2	80		4/9/100 + 2/6,5/90	177381
120	0,5	80		4/9/100 + 2/6,5/90	177382
120	1,0	80		4/9/100 + 2/6,5/90	177383
120	2,0	80		4/9/100 + 2/6,5/90	177384
120	3,0	80		4/9/100 + 2/6,5/90	177385
130	0,5	80			000450 s
145	0,1	80		4/12/100 + 4/9/120	552104
145	0,2	80		4/12/100 + 4/9/120	552105
145	0,5	80		4/12/100 + 4/9/120	552106
145	1,0	80		4/12/100 + 4/9/120	552107
150	1,6	75		6/6,5/95	189542
175	7,6	70			186163 s
175	11,4	70			181034
[mm]	[mm]	[mm]	[mm]		

955521

Spacer Sets - 4 parts

Notes

| 4 piece set consists of: 1 piece 0.1 mm, 1 pieces 0.2 mm, 2 piece 0.3 mm

Ø D	B	Ø d	NL	Ident-No.
74	0,9	22	2/4/42	80272800
[mm]	[mm]	[mm]		

955521

Spacer Sets - 8 parts for milling spindles

Notes

| for milling spindles

| 8 piece set consists of: 2 pieces 5 mm, 1 piece 8 mm, 1 piece 10 mm, 2 pieces 16 mm, 1 piece 25 mm, 1 piece 40 mm

Ø D	B	Ø d	Ident-No.
50	125	30	160233 o
60	125	40	160234 o
[mm]	[mm]	[mm]	



955521

Spacer Sets - 9 parts

Notes

| 9 piece set consists of: 1 piece 0.1 mm, 2 pieces 0.2 mm, 1 piece 0.5 mm, 3 pieces 1.0 mm, 1 piece 4.0 mm, 1 piece 10 mm

Ø D	B	Ø d	Ident-No.
65	18	30	161797
70	18	35	161798 s
70	18	40	161799 s
[mm]	[mm]	[mm]	

995520

Spacers for s-System - Homag

Notes

| for s-System - Homag

Ø D	B	Ø d	DKN	Ident-No.
60	11	35	10x3,3	180647
[mm]	[mm]	[mm]	[mm]	

955520

Spacer rings - steel

Product

Notes

| Spacer rings for sawmills
| Other designs and dimensions on request



Ø D	B	Ø d	DKN	Ident-No.
150	0,5	115	29x131	80370453 s
150	1,0	115	29x131	80370454 s
190	2,0	150	36,3x167	80383237 s
190	3,0	150	36,3x167	80383238 s
190	5,0	150	36,3x167	80383239 s
190	10,5	150	37x170	80387052 s
190	11,5	150	37x170	80387053 s
190	12,5	150	37x170	80387054 s
190	40,4	150	37x170	80387912 s
200	1,0	150	37x157,8	80291659 s
200	2,0	150	37x157,8	80291660 s
200	3,0	150	37x157,8	80291661 s
200	6,8	150	37x157,8	80404151 s
200	21,6	150	37x157,8	80291663 s
200	31,6	150	37x157,8	80291662 s
220	10,4	150	37x170	80283020 s
270	10	150	36,3x167	80363407 s
270	30	150	36,5x168	80386011 s
270	150	150	36,3x167	80354756 s
320	10,4	150	37x170	80283019 s
[mm]	[mm]	[mm]	[mm]	

955520

Spacer rings - aluminum, stepped

Product

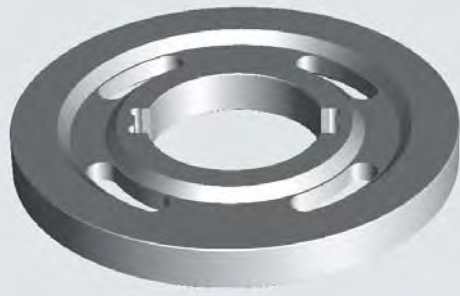

Notes

- | Spacer rings for sawmills
- | Other designs and dimensions on request

Ø D	B	Ø d	DKN	Ident-No.
380	37,7	150	37x170	80187182 s
[mm]	[mm]	[mm]	[mm]	



955530

Reducing Rings

Notes

! this bore can only be reduced if the direct clamping of the saw blade via clamping rings or flanges is guaranteed

Ø D	B	Ø d	Ø d	Ident-No.
20	1,6	12,7	1/2"	161946
20	1,6	16		161945
22	2,0	20		161887
22	4,0	20		161830
25	2,2	20		000104
30	1,4	15		000107 s
30	1,4	16		000111
30	1,4	20		000117
30	1,4	25		000125
30	1,8	15,1	19/32"	161949 #
30	1,9	16		000112
30	1,9	20		000118
30	2,0	20		016848
30	2,0	25		000127 s
30	2,2	15,88	5/8"	000110 s
30	2,2	16		000113
30	2,2	18		000114
30	2,2	20		000119
30	2,2	22		000120
30	2,2	25		000128
30	2,2	25,4	1"	000130
30	2,2	28		000132
30	3,0	25		000129
32	2,0	16		161886
32	2,2	16		000134 s
32	2,2	20		000135 s
32	2,2	22		010571
32	2,2	30		000137
35	1,0	30		000145
35	1,4	30		000146 s
35	1,9	30		000147
35	2,2	20		000138
35	2,2	24		000139 s
35	2,2	25		000142
35	2,2	28		000144 s
35	2,2	30		000148
35	2,2	32		000150 s
40	2,0	32		161962
40	2,2	20		000151
40	2,2	30		000153
40	2,2	35		000154 s
45	2,5	30		161831
50	2,2	30		000156
55	2,2	30		000159
60	2,2	30		000161
60	2,2	35		000162
60	2,2	40		000163 s
60	2,2	50		000164
60	2,8	30		010577
70	2,2	30		000166 s
80	2,2	30		000171
80	2,2	35		000172 s
80	2,2	50		000175 s
80	2,2	60		000177 s
80	2,2	70		000179 s
80	2,8	60		000178 s
[mm]	[mm]	[mm]	[inch]	

956506

Reducing Bushing

Notes

- | cylindrical
- | bore tolerance H7

Ø D	B	Ø d	Ø d	Ident-No.
30	5,1-10	20		000411 s
30	5,1-10	25		000415 &
30	10,1-25	20		000441 o
30	10,1-25	25		000445 &
30	15,1-20		1"	000726 &
30	15,1-20	20		000721 o
30	15,1-20	25		000725 &
30	20,1-25		1"	000756 o
30	20,1-25	25		000755 &
30	25,1-30		1"	000786 &
30	25,1-30	20		000781 o
30	25,1-30	25		000785 &
30	30,1-40		1"	000816 &
30	30,1-40	20		000811 &
30	30,1-40	25		000815 &
30	40,1-50		1"	000846 &
30	40,1-50	25		000845 o
30	50,1-60	25		000875 &
30	60,1-80		1"	000365 s
30	60,1-80	20		000360 s
30	60,1-80	25		000364 s
35	5,1-10	20		000420 &
35	5,1-10	30		000424 &
35	10,1-25	30		000704 &
35	15,1-20		1 1/4"	000735 &
35	15,1-20	30		000734 &
35	20,1-25		1 1/4"	000765 &
35	20,1-25	30		000764 &
35	25,1-30		1 1/4"	000795 o
35	25,1-30	30		000794 &
35	30,1-40		1 1/4"	000825 &
35	30,1-40	30		000824
35	40,1-50	30		000854 &
35	50,1-60		1 1/4"	000885 &
35	50,1-60	30		000884 &
35	60,1-80		1 1/4"	000374
35	60,1-80	20		000369 s
35	60,1-80	30		000373
40	5,1-10	20		000428 &
40	5,1-10	25		000429 &
40	5,1-10	30		000430 &
40	5,1-10	35		000891 &
40	10,1-25	20		000708 &
40	10,1-25	30		000710 &
40	10,1-25	35		000912 &
40	15,1-20	30		000740 &
40	15,1-20	35		000933 &
40	20,1-25	25		000769 &
40	20,1-25	30		000770 &
40	25,1-30	30		000800 &
40	25,1-30	35		000975 o
40	30,1-40	20		000828 &
40	30,1-40	25		000829 &
40	30,1-40	30		000830 &
40	30,1-40	35		000996 &
40	40,1-50	30		000860 &
[mm]	[mm]	[mm]	[inch]	



Ø D	B	Ø d	Ø d	Ident-No.
40	40,1-50	35		001017 &
40	50,1-60	30		000890 &
40	50,1-60	35		001038 &
40	60,1-80	20		000377 s
40	60,1-80	25		000378 s
40	60,1-80	30		000379
40	60,1-80	35		000380
60	5,1-10	30		000899 &
60	5,1-10	35		000900 &
60	5,1-10	40		000901 &
60	10,1-25	30		000920 &
60	10,1-25	35		000921 &
60	10,1-25	40		000922 &
60	15,1-20	30		000941 &
60	15,1-20	35		000942 &
60	15,1-20	40		000943 &
60	20,1-25	30		000962 &
60	20,1-25	35		000963 &
60	25,1-30	30		000983 &
60	25,1-30	35		000984 &
60	25,1-30	40		000985 &
60	30,1-40	30		001004 &
60	30,1-40	35		001005 &
60	30,1-40	40		001006 &
60	40,1-50	30		001025 &
60	40,1-50	35		001026 &
60	40,1-50	40		001027 &
60	50,1-60	35		001047 &
60	50,1-60	40		001048 &
60	60,1-80	30		000388
60	60,1-80	35		000389
60	60,1-80	40		000390
80	5,1-10	30		000905 &
80	10,1-25	40		000928 &
80	15,1-20	30		000947 &
80	15,1-20	35		000948 &
80	15,1-20	40		000949 &
80	20,1-25	35		000969 &
80	20,1-25	40		000970 &
80	25,1-30	30		000989 &
80	25,1-30	35		000990 &
80	30,1-40	35		001011 &
80	30,1-40	40		001012 &
80	40,1-50	30		001031 &
80	40,1-50	35		001032 &
80	40,1-50	40		001033 &
80	50,1-60	35		001053 &
80	60,1-80	30		000394 s
80	60,1-80	35		000395 s
80	60,1-80	40		000396 s
80	10,1-25	30		000926 &
80	10,1-25	35		000927 &
80	5,1-10	35		000906 &
80	5,1-10	40		000907 &
[mm]	[mm]	[mm]	[inch]	

956506

Reducing Bushings with collar

Drawing

Notes

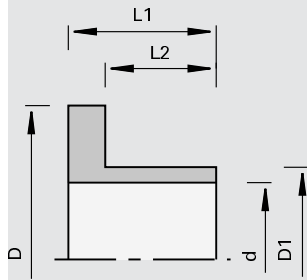

I with collar

Ø D	Ø D1	Ø d	L1	L2	Ident-No.
60 [mm]	40 [mm]	30 [mm]	24 [mm]	18 [mm]	168063 s



997500

Ball Bearings

Notes

| for shank-type tools

Dimension

Ident-No.

ball-bearing thrust ring assy.	Ø12	167923
ball-bearing thrust ring assy.	Ø14	169314
Ball Bearings	12,7x5x4,76	164920
Ball Bearings	15,9x5x6,35	164921
Ball Bearings	19x6x6	164922
Ball Bearings	22x7,5x8	180838
ball-bearings with thrust ring	19x7,5x6,35	164229
ball-bearings with thrust ring	21x7,5x6,35	170774 o
ball-bearings with thrust ring	22x7,5x6,35	164228
	[mm]	

955550

Rub Collars

Drawing

Notes

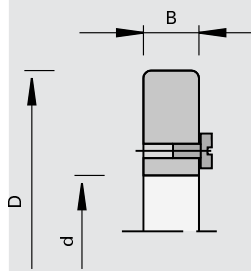

- | for use on ball bearing bushing
- | intermediate dimensions available upon request
- | screw for axial locking: cap screw M4x10 DIN 84 Ident-No. 001730

Ø D	B	Ø d	Ident-No.
75	10	62	160205 #
80	10	62	160206 #
100	10	62	160210 #
105	10	62	160211 #
150	10	62	160219 #
[mm]	[mm]	[mm]	

955550

Ball Bearing Ring Set

Product



Drawing

Machine / Application

I for Ø 90 mm - Ø 130 mm

Design

I wood box with with ball bearing, safety screws, cover discs and thrust rings

Advantages

Notes

Ø d	Ø D	Ident-No.
30 [mm]	90/95/100/105/110/115/120/125/130 [mm]	50592754

Spare parts	Dimension	Class-No.	PU	Ident-No.
Countersunk Screws	M6x14 DIN 963	995121	10	50947932 s
Spacers	D=48	955520	2	50592771
Ball Bearing Bushings	55/30X13 [mm]	997500	1	50592751 [pc.]



985720

Engineers Wrenches

Dimension	Ident-No.
9x11 DIN 3118	168672 o
11x13 DIN 3118	168670 o
14x17 DIN 3118	168671 s
SW10/13 DIN 895	171060 o
[mm]	

985720

Single-Head Engineers Wrenches

Dimension	Ident-No.
SW36 DIN 894	169296 o
SW41 DIN 894	169297 s
SW46x10 DIN 894	178760
[mm]	

985720

Hook Wrenches

Product	Notes
	for draw-in collet chucks
Dimension	Ident-No.
40/42 DIN 1810	169298
45/50 DIN 1810	175851
58/62 DIN 1810	169299
[mm]	

985300

Hook wrench adapter for torque wrench

Product	Notes
	for draw-in collet chucks use with torque wrench, ID No 184890
Dimension	Ident-No.
40/43 DIN 1810	186466 o
45/50 DIN 1810	186467 o
58/62 DIN 1810	186765
[mm]	

985720

Hand spanner

Product



Notes

| for draw-in collet chucks with internal clamping nut

Ident-No.

426E / ER 16

184878

470E / ER 32

184879

462E / OZ 25

184880

985300

Torque adapter for torque wrench

Product



Notes

| for draw-in collet chucks with internal clamping nut
| use with torque wrench, ID No 184890

Ident-No.

426 E / ER 16

184887

470 E / ER 32

184888

462 E / OZ 25

184889

985300

Torque wrench

Dimension

40-200 Nm

[mm]

Ident-No.

184890

985730

Cranked Wrench Keys for hexagon socket screws

Notes

| for hexagon socket screws

Dimension

SW2 DIN ISO 2936

009670 s

SW2,5 DIN ISO 2936

009671

SW3 DIN ISO 2936

009672

SW4 DIN ISO 2936

009673

SW5 DIN ISO 2936

009674

SW6 DIN ISO 2936

009675

SW6x100

180383 o

SW8 DIN ISO 2936

009677 s

SW12 DIN 6911

177106

[mm]



985730

Screwdrivers with sliding handle for hexagon socket

Notes

- | for hexagon socket screws
- | with sliding handle

Dimension	Ident-No.
SW2,5x100	168010
SW3x100	166090
SW4x100	166091
SW5x150	168703
SW6x200	167817
[mm]	

985730

Screwdrivers with sliding handle for Torx

Notes

- | for screws with Torx
- | with sliding handle

Dimension	Ident-No.
T20x100	166092
T25x100	50933169 #
T40x130	831404 o
[mm]	

985730

Screwdrivers with flag for Torx

Notes

- | for screws with Torx
- | with flag

Dimension	Ident-No.
T7	167904
T8	166499
T9	164344
T15	163161
[mm]	

985730

Cranked Wrench Keys for Torx

Notes

- | for screws with Torx

Dimension	Ident-No.
T15	for adjustment unit Altendorf 181147
T30x100	50933102
[mm]	

985730

Screwdrivers with spinner handle for Torx

Notes

- | for screws with Torx
- | with spinner handle

Dimension	Ident-No.
T9x60	173796
T15x80	171188
T15x140	179145
[mm]	

985730

Screwdrivers with spinner handle

Notes

- | with spinner handle

Dimension	Ident-No.
8,0	053874
[mm]	

985730

Screwdrivers with wooden handle

Notes

- | with wooden handle

Dimension	Ident-No.
9,0	011088
[mm]	

985200

Adjusting Gauges

Dimension	Ident-No.
0,3	055883
0,5	50570583
0,7	056096
0,8	50570581
1,0	011103
1,8	50570582
[mm]	

997800

Magnetic Stops

Dimension	Ident-No.
0,0	016613
0,5	166093
1,0	166094
[mm]	



985710

Ball hammers one sided

Product



Notes

| Hand tools for straightening circular saw blades

Weight

Ident-No.

0.5	186268 s
0.75	186269 s
1.0	186270 s
1.25	186271 s
1.5	186272 s
1.75	186273 s
2.0	186274 s
2.25	186275 s
2.5	186276 s
3.0	186277 s
[kg]	

985710

Ball hammers double sided

Product



Notes

| Hand tools for straightening circular saw blades

Weight

Ident-No.

0.5	186257 s
0.75	186258 s
1.0	186259 s
1.25	186260 s
1.5	186261 s
1.75	186262 s
2.0	186263 s
2.25	186264 s
2.5	186265 s
3.0	186266 s
3.5	186267 s
[kg]	

985710

Cross hammers

Product

Notes



| Hand tools for straightening circular saw blades

Weight

Ident-No.

0.5	186278 s
0.75	186279 s
1.0	186280 s
1.25	186281 s
1.5	186282 s
1.75	186283 s
2.0	186284 s
2.25	186285 s
2.5	186286 s
[kg]	

985710

Roughing hammers

Product

Notes



| Hand tools for straightening circular saw blades

Weight

Ident-No.

0.5	186287 s
0.75	186288 s
1.0	186289 s
1.25	186290 s
1.5	186291 s
1.75	186292 s
2.0	186293 s
2.25	186294 s
2.5	186295 s
[kg]	



985300

Rulers

Product

Notes



| Hand tools for straightening circular saw blades

Total length

Ident-No.

150	186296 o
200	186297 o
300	186298 o
400	186299 o
500	186300 o
600	186301 o
800	186302 o
[mm]	

985300

Dial gauges

Product



Ident-No.

186304 o

985300

Saw setting dial gauges

Product



Ident-No.

186303 o

997600

Drilling fixture for p-System profile cutters

Product

Drawing



Machine / Application

Design

Advantages

Notes

| Drilling fixture to repair p-System profile cutters

| with positioning screws

| fast and easy positioning on the profile cutter
| Stable guidance of the drill bits

| appropriate repair set consisting of: thread inserts, twist drills, hand tap, spindle insert, tang break-off tool (identification no. 185881)

Ident-No.

for Ø D=360 mm left and Helicoil® d=7.5 mm	186440 s
for Ø D=360 mm right and Helicoil® d=7.5 mm	186441 s
for Ø D=402 mm left and Helicoil® d=7.5 mm	186444 s
for Ø D=402 mm right and Helicoil® d=7.5 mm	186445 s
for Ø D=360 mm left and core hole d=5.5 mm	186442 s
for Ø D=360 mm right and core hole d=5.5 mm	186443 s
for Ø D=402 mm left and core hole d=5.5 mm	186446 s
for Ø D=402 mm right and core hole d=5.5 mm	186447 s

